

Stravilink PSJ^{*}

Datasheet

Stravilink PSJ is an [Elastomer Isolated Joist Hanger](#) designed to support suspended ceiling systems, optimising sound insulation between vertically stacked rooms.



BENEFITS

- Cost effective
- Quick and easy to install
- Standard hangers are as follows:
 - Stravilink PSJ-150 10-20 kg per hanger
 - Stravilink PSJ-350 20-45 kg per hanger
- Natural frequency between 12Hz and 18Hz
- Can be used to hang down most suspended ceiling systems
- Steel elements are Zinc plated
- Bespoke hangers can be manufactured to meet specific loading and natural frequency requirements on request
- System comes with perimeter isolation strip to isolate the perimeter of the ceiling from the surrounding structures
- To specify which Stravilink PSJ hangers you require CDM Stravitec's engineers will need the following information:
 - The weight and construction of the supported ceiling - this will determine the type of hanger
 - The weight of any elements supported off the suspended ceiling or directly off a hanger
 - The required void between the supporting soffit and the suspended ceiling

^{*}Previously known as CDM-PSJ



TYPICAL ASSEMBLIES

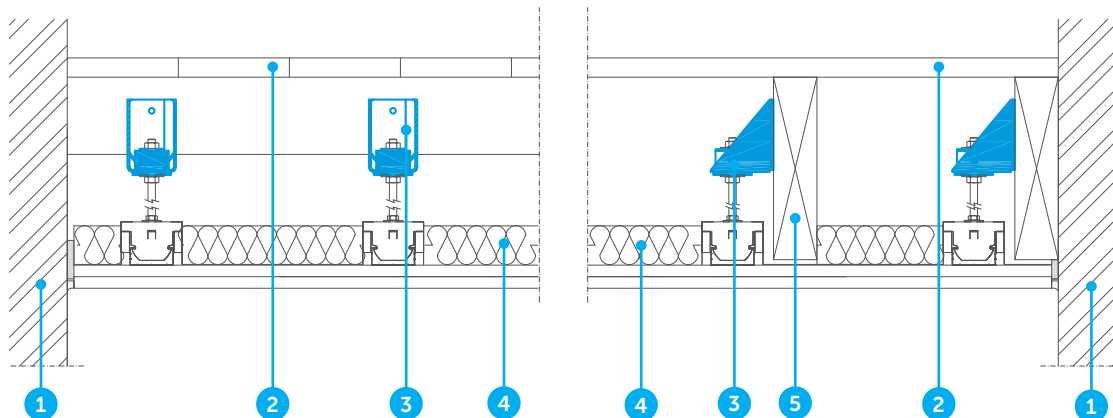

1. Wall
2. Flooring
3. Stravilink PSJ

4. Absorption layer
5. Floor joist

DISCLAIMER

This information is accurate to the best of our knowledge at the time of issue. Information, data and recommendations provided are based on industry accepted testing and prior product usage. It is intended as descriptive of the general capabilities and performance of our products and does not endorse applicability for any particular project. We reserve the right to change products, performance, and data without notice. This document replaces all information supplied prior to the publication hereof.