

MINIMUM SYSTEM TOTAL BUILD-UP HEIGHT (BEFORE DEFLECTION): 95mm

First submission	2025/07/28	VPR	A
Revision Description	Date	Drawn	Rev.

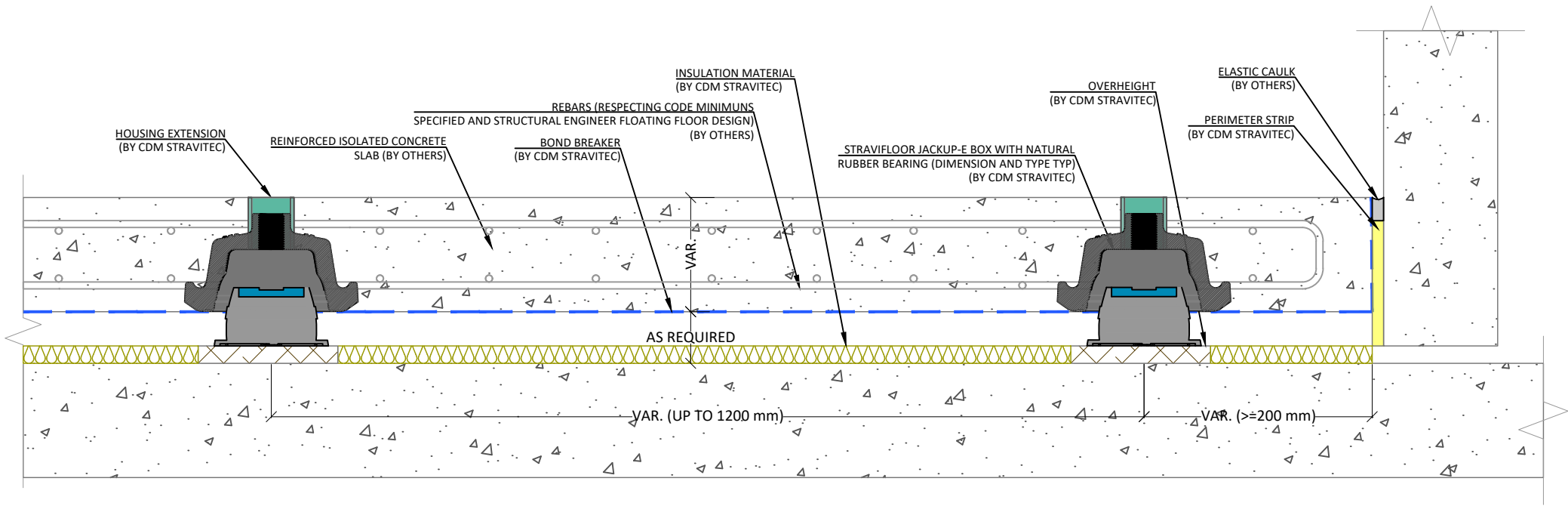

Notes	
System	Stravifloor Jackup-E (EN)
1. The structural floor should comply with the required tolerances regarding gradient (0,1 % or 1 mm/m) and smoothness (max. 2 mm). It should be dry and free of obstacles, discontinuities, dust, etc.	
2. A rigid connection should be avoided between the floating slab and all vertical elements (as walls, columns, ...) by adding a void or a layer of lateral isolation between the isolated slab and the vertical element.	
For more detailed information ask for Stravifloor Jackup-E Installation Manual.	

MINIMUM SYSTEM TOTAL BUILD-UP HEIGHT (BEFORE DEFLECTION): 95mm + INSULATION MATERIAL THICKNESS

Legend

First submission	2025/07/28	VPR	A
Revision Description	Date	Drawn	Rev.

Load table

Drawing based on



Reutenbeek 9-11
B-3090 Overijse Belgium
PH: +32 2 687 79 07
FX: +32 2 687 35 52
info@cdm-stravitec.com
www.cdm-stravitec.com

This drawing is exclusive property of CDM Stravitec, any reproduction or communication to third parties without prior authorisation is prohibited.

STRAVIFLOOR JACKUP-E WITH ELASTOMERIC BEARINGS, FRAME OVERHEIGHT AND INSULATION MATERIAL

\$(GETVAR,- \$(GETVAR,??)

Drawn:	2025/07/28	Scale:	1 : 5
Design:		Format:	A3
Check:			
CRU			

MINIMUM SYSTEM TOTAL BUILD-UP HEIGHT (BEFORE DEFLECTION): 95mm +
INSULATION MATERIAL THICKNESS

First submission	2025/07/28	VPR	A
Revision Description	Date	Drawn	Rev.

1000-0000 0000-0000

100-000 000-000

Reutenbeek 9-11
B-3090 Overijse Belgium
PH: +32 2 687 79 07
FX: +32 2 687 35 52
info@cdm-stravitec.com
www.cdm-stravitec.com

This drawing is exclusive property of CDM Stravitec, any reproduction or communication to third parties without prior authorisation is prohibited.

100

STRAVIFLOOR JACKUP-E PAD-M

TYPICAL TOP VIEW

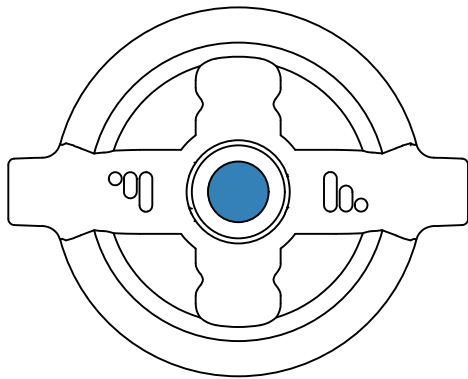

Notes	
System	Stravifloor Jackup-E (EN)
<div>1. The structural floor should comply with the required tolerances regarding gradient (0,1 % or 1 mm/m) and smoothness (max. 2 mm). It should be dry and free of obstacles, discontinuities, dust, etc.</div> <div>2. A rigid connection should be avoided between the floating slab and all vertical elements (as walls, columns, ...) by adding a void or a layer of lateral isolation between the isolated slab and the vertical element.</div> <div>For more detailed information ask for Stravifloor Jackup-E Installation Manual.</div>	

MINIMUM SYSTEM TOTAL BUILD-UP HEIGHT (BEFORE DEFLECTION): 95mm + INSULATION MATERIAL THICKNESS

Legend

First submission	2025/07/28	VPR	A
Revision Description	Date	Drawn	Rev.

Load table

Drawing based on



Reutenbeek 9-11
B-3090 Overijse Belgium
PH: +32 2 687 79 07
FX: +32 2 687 35 52
info@cdm-stravitec.com
www.cdm-stravitec.com

This drawing is exclusive property of CDM Stravitec, any reproduction or communication to third parties without prior authorisation is prohibited.

STRAVIFLOOR JACKUP-E PAD-M TYPICAL TOP VIEW

\$(GETVAR,- \$(GETVAR,??)

Drawn:
VPR2025/07/28

Design:

Check:
CRU

Scale:
1 : 2

Format:
A3

