

Notes

Legend

First submission	31/03/2025	LCH	A
Revision Description	Date	Drawn	Rev.

Load table

Drawing based on

cdm **stravitec**

Reutenbeek 9-11
B-3090 Overijse Belgium
PH: +32 2 687 79 07
info@cdm-stravitec.com
www.cdm-stravitec.com

This drawing is exclusive property of CDM Stravitec, any reproduction or communication to third parties without prior authorisation is prohibited.

Stravilink DCH-S
47/60 mm channel

Typical Cross Section - Stravilink

DCH-S (EU)-01
LCH 31/03/2025

Design:

Check:
JMI

Scale:

1:4

Format:

A3

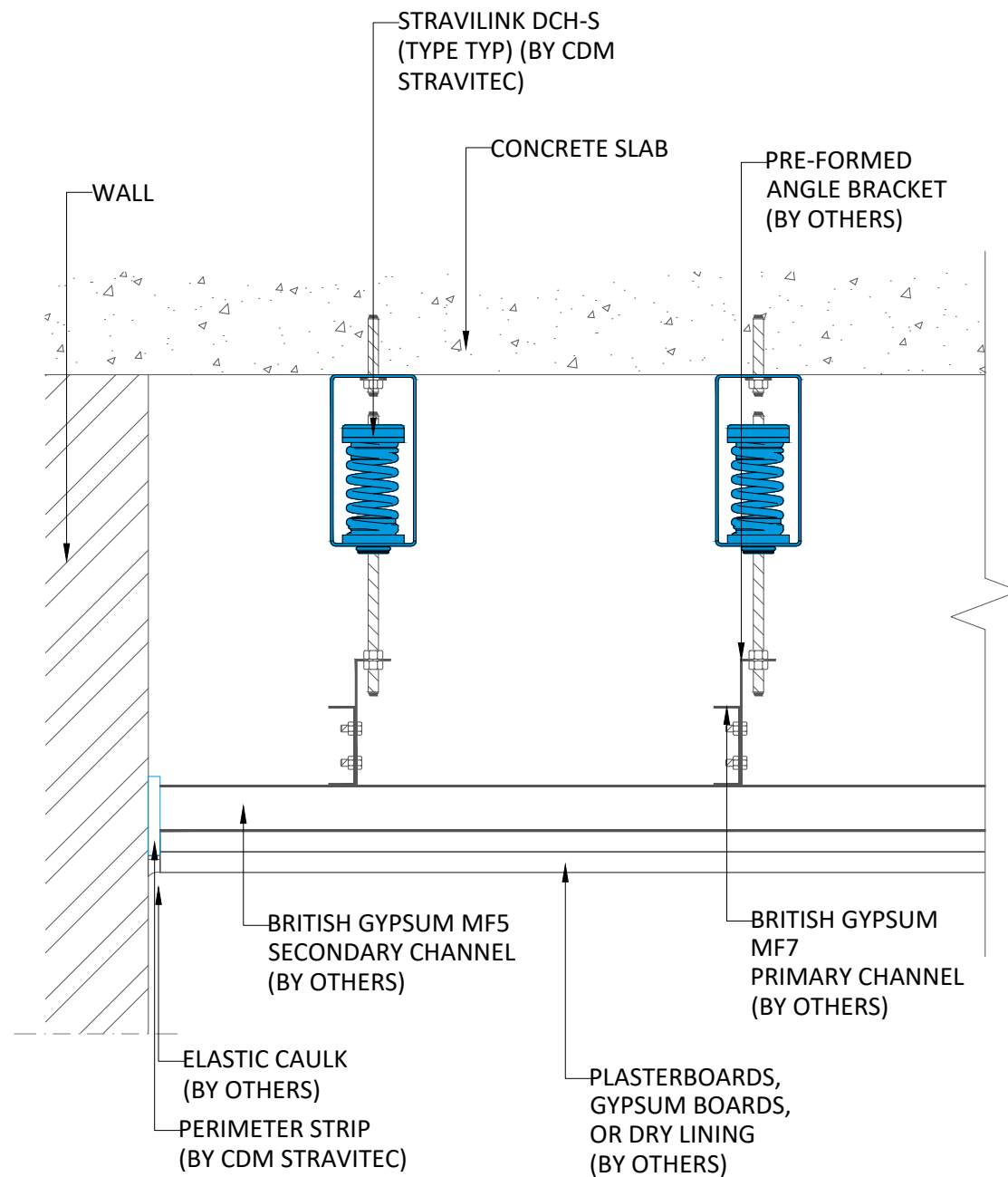

Notes
-

Legend

First submission	31/03/2025	LCH	A
Revision Description	Date	Drawn	Rev.

Load table
-

Drawing based on
-

cdm **stravitec**
Reutenbeek 9-11
B-3090 Overijse Belgium
PH: +32 2 687 79 07
info@cdm-stravitec.com
www.cdm-stravitec.com

This drawing is exclusive property of CDM Stravitec, any reproduction or communication to third parties without prior authorisation is prohibited.

Stravilink DCH-S
MF grid option 1

Typical Cross Section - Stravilink
DCH-S (EU)-02
LCH 31/03/2025
Design: ---
Check: JMI
Scale: 1:4
Format: A3

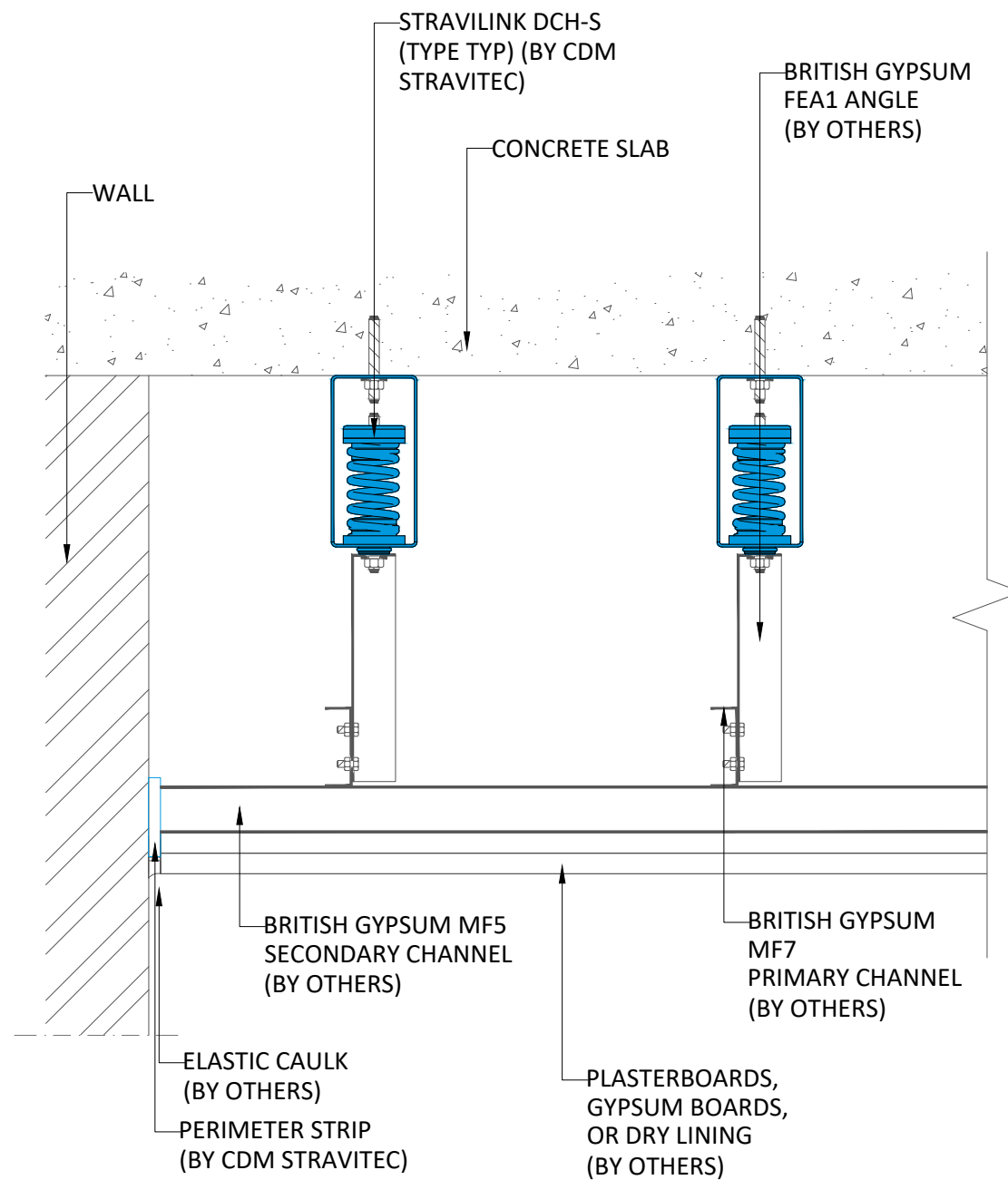

Notes
-

Legend

First submission	31/03/2025	LCH	A
Revision Description	Date	Drawn	Rev.

Load table
-

Drawing based on
-

cdm **stravitec**
Reutenbeek 9-11
B-3090 Overijse Belgium
PH: +32 2 687 79 07
info@cdm-stravitec.com
www.cdm-stravitec.com

This drawing is exclusive property of CDM Stravitec, any reproduction or communication to third parties without prior authorisation is prohibited.

Stravilink DCH-S
MF grid option 2

Typical Cross Section - Stravilink
DCH-S (EU)-03
Drawn: LCH
Date: 31/03/2025
Design: ---
Check: JMI
Scale: 1:4
Format: A3