



Stravilink PHS-S^{*}

Datasheet

Stravilink PHS-S Elastomer Acoustic Suspension Hangers have been designed to support suspended ceiling and wall systems as well as to decouple equipment or ductwork

BENEFITS

- Cost effective
- Quick and easy to install
- Standard hangers are as follows:

Stravilink PHS-S-150	10-20 kg (22-44 lbs) per hanger
Stravilink PHS-S-350	20-45 kg (44-99 lbs) per hanger
Stravilink PHS-S-600	40-90 kg (88-198 lbs) per hanger
- Natural frequency between 12 and 18Hz
- Can be used to hang down most suspended ceiling systems
- Variable void depths are achievable (Stravilink PHS-S hanger depth is 50 mm (2"))
- Steel elements are Zinc plated
- For optimum results a resilient perimeter strip should be used to provide lateral isolation between the suspended ceiling and adjacent walls. A wide range of roll sizes are available
- To specify which Stravilink PHS-S hangers you require, CDM Stravitec's engineers will need the following information:
 - The weight and construction of the supported ceiling
 - The weight of any elements supported off the suspended ceiling or directly off a hanger
 - The required void between the supporting soffit and the suspended ceiling

*Previously known as CDM-PHS-S



TYPICAL ASSEMBLIES

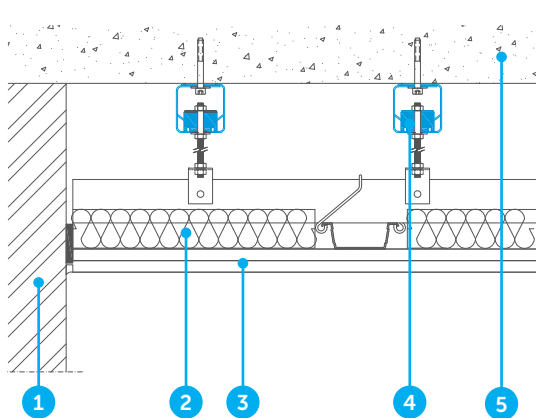

1. Wall
2. Absorption layer
3. Plasterboards, gypsum board or dry lining

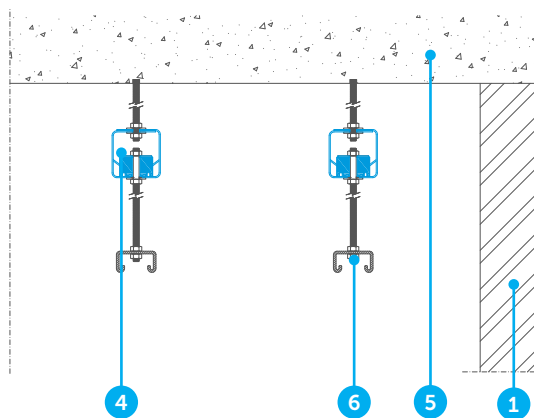

4. Stravilink PHS-S
5. Structural reinforced concrete slab
6. Stravilink CC40 or CC60

DISCLAIMER

This information is accurate to the best of our knowledge at the time of issue. Information, data and recommendations provided are based on industry accepted testing and prior product usage. It is intended as descriptive of the general capabilities and performance of our products and does not endorse applicability for any particular project. We reserve the right to change products, performance, and data without notice. This document replaces all information supplied prior to the publication hereof.