

Submittal Drawing Stravilink ICH-S (Heavy Frame)

Isolated Ceiling Hanger with Springs

Project:

Customer:

Drawing #:

PO #:

Date:

FRONT VIEW

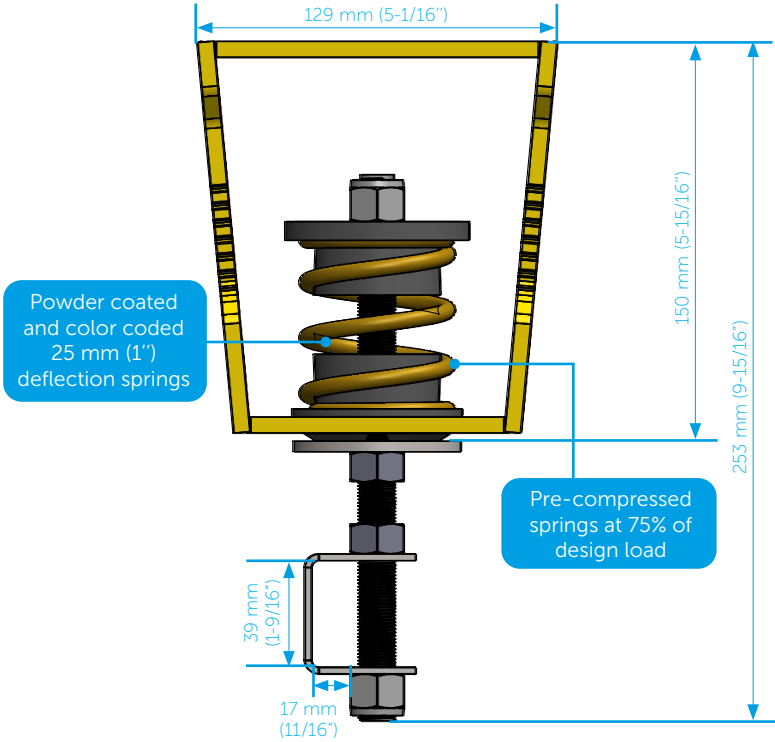

SIDE VIEW

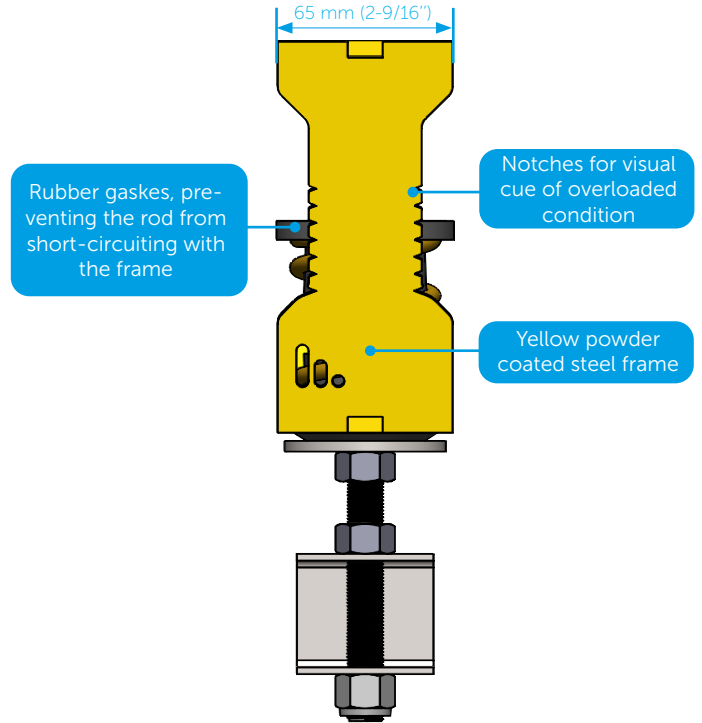

TOP VIEW

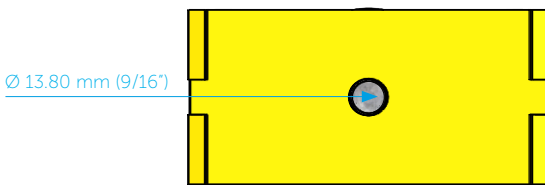

Property	According to standard	Result
Spring parameters	EN 15800:2008	ok
Spring creep	ISO 8013:2019	ok
Deflection at design	EN 15800:2008	ok
Admissible load	EN 13964:2014	ok
Coating thickness	EN 12944-6:2018	ok
Elastomer stiffness	ISO 48-4	ok

Model	Design Load at 25 mm (1") Deflection		Load Range		Spring Color	Quantity
	lbs	N	lbs	N		
ICH-S200	200	890	67-300	445-1335	Curry ●	
ICH-S250	250	1110	85-375	555-1670	Mint Green ●	
ICH-S350	350	1560	118-525	780-2340	Orange Brown ●	
ICH-S450	450	2000	151-675	1000-3000	Pearl Night Blue ●	
ICH-S550	550	2450	195-875	1225-3670	Anthracite Grey ●	

Notes:

- (1) All springs with 25 mm (1") deflection at design load (natural frequency of 3.1 Hz).
- (2) All springs have minimum additional travel to solid equal to 70% of design deflection.
- (3) Maximum load on complete assembly as supplied by CDM Stravitec: 1,428 lbs (6,350 N), according to N_EN 13964:2014 (tested until 100 mm (4") deformation due to testing equipment limitations).

CANADA TORONTO / T (905) 265-7401

UNITED STATES LANCASTER / T (888) 454-6236

ORDERS-NA@CDM-STRAVITEC.COM / WWW.CDM-STRAVITEC.COM

Notes:

Submittal Drawing Stravilink ICH-S (Heavy Frame)

Isolated Ceiling Hanger with Springs

Project:

Customer:

Drawing #:

PO #:

Date:

FRONT VIEW

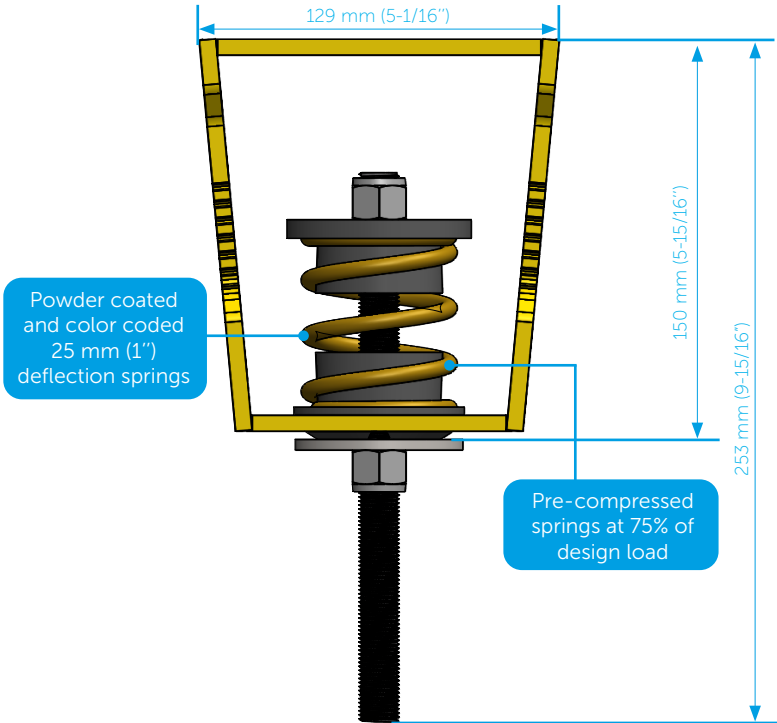

SIDE VIEW

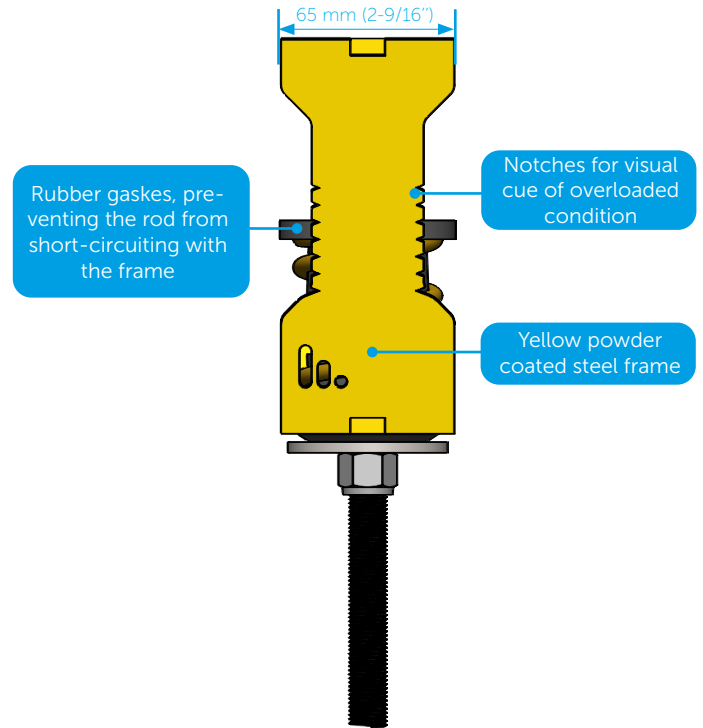

TOP VIEW

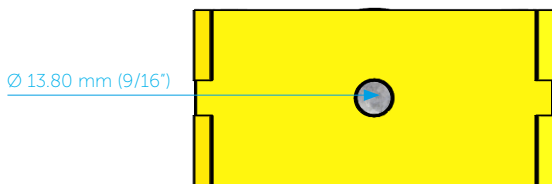

Property	According to standard	Result
Spring parameters	EN 15800:2008	ok
Spring creep	ISO 8013:2019	ok
Deflection at design	EN 15800:2008	ok
Admissible load	EN 13964:2014	ok
Coating thickness	EN 12944-6:2018	ok
Elastomer stiffness	ISO 48-4	ok

Model	Design Load at 25 mm (1") Deflection		Load Range		Spring Color	Quantity
	lbs	N	lbs	N		
ICH-S200	200	890	67-300	445-1335	Curry ●	
ICH-S250	250	1110	85-375	555-1670	Mint Green ●	
ICH-S350	350	1560	118-525	780-2340	Orange Brown ●	
ICH-S450	450	2000	151-675	1000-3000	Pearl Night Blue ●	
ICH-S550	550	2450	195-875	1225-3670	Anthracite Grey ●	

Notes:

- (1) All springs with 25 mm (1") deflection at design load (natural frequency of 3.1 Hz).
- (2) All springs have minimum additional travel to solid equal to 70% of design deflection.
- (3) Maximum load on complete assembly as supplied by CDM Stravitec: 1,428 lbs (6,350 N), according to N_EN 13964:2014 (tested until 100 mm (4") deformation due to testing equipment limitations).

CANADA TORONTO / T (905) 265-7401

UNITED STATES LANCASTER / T (888) 454-6236

ORDERS-NA@CDM-STRAVITEC.COM / WWW.CDM-STRAVITEC.COM

Notes:

Submittal Drawing Stravilink ICH-S (Heavy Frame)

Isolated Ceiling Hanger with Springs

Project:

Customer:

Drawing #:

PO #:

Date:

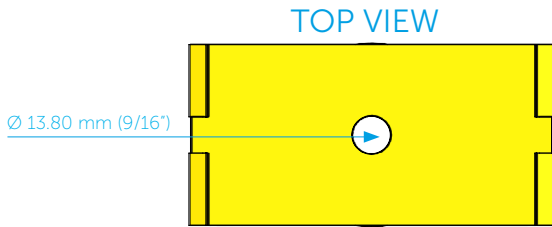
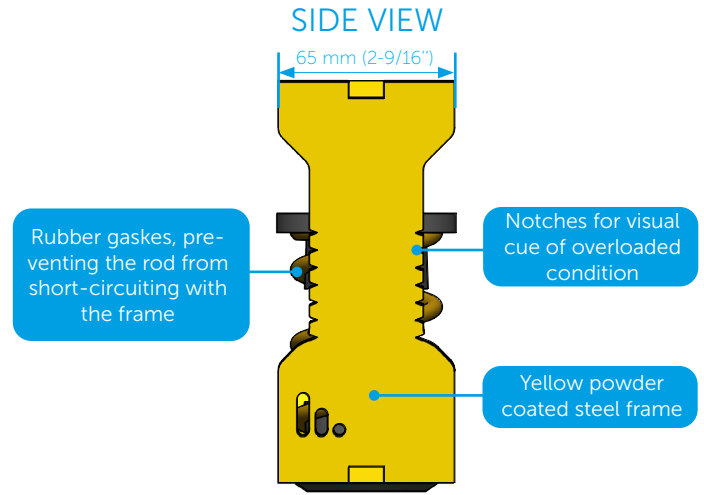
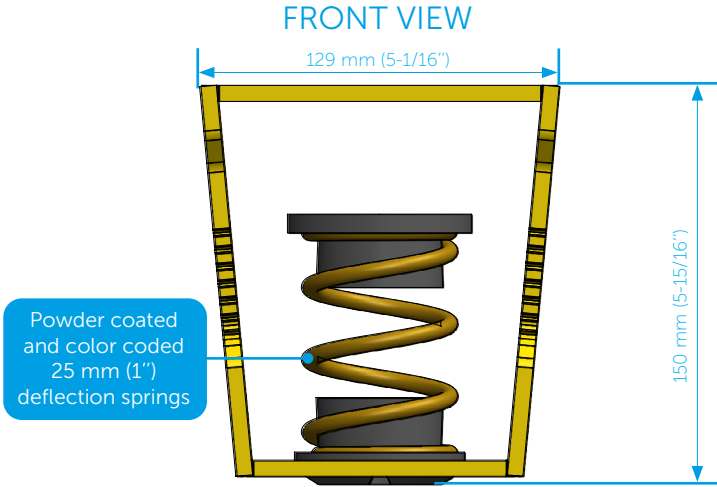

Property	According to standard	Result
Spring parameters	EN 15800:2008	ok
Spring creep	ISO 8013:2019	ok
Deflection at design	EN 15800:2008	ok
Admissible load	EN 13964:2014	ok
Coating thickness	EN 12944-6:2018	ok
Elastomer stiffness	ISO 48-4	ok

Model	Design Load at 25 mm (1") Deflection		Load Range		Spring Color	Quantity
	lbs	N	lbs	N		
ICH-S200	200	890	67-300	445-1335	Curry ●	
ICH-S250	250	1110	85-375	555-1670	Mint Green ●	
ICH-S350	350	1560	118-525	780-2340	Orange Brown ●	
ICH-S450	450	2000	151-675	1000-3000	Pearl Night Blue ●	
ICH-S550	550	2450	195-875	1225-3670	Anthracite Grey ●	

Notes:

- (1) All springs with 25 mm (1") deflection at design load (natural frequency of 3.1 Hz).
- (2) All springs have minimum additional travel to solid equal to 70% of design deflection.
- (3) Maximum load on complete assembly as supplied by CDM Stravitec: 1,428 lbs (6,350 N), according to N_EN 13964:2014 (tested until 100 mm (4") deformation due to testing equipment limitations).

Notes: