

Notes	
System	Stravifloor Deck (EN)
<div>1. The structural floor should comply with the required tolerances regarding gradient (0,1 % or 1 mm/m) and smoothness (max. 2 mm). It should be dry and free of obstacles, discontinuities, dust, etc.</div> <div>2. A rigid connection between the floating slab and any vertical elements (e.g. walls, columns, ...) should be avoided by adding a perimeter strip between the isolated slab and the vertical element.</div>	
For more detailed information ask for Stravifloor Deck Installation Manual.	
MINIMUM SYSTEM TOTAL BUILD-UP HEIGHT (BEFORE DEFLATION): 107mm	

Legend

First submission	2025/07/23	VPR	A
Revision Description	Date	Drawn	Rev.

Load table

Drawing based on



Reutenbeek 9-11
B-3090 Overijse Belgium
PH: +32 2 687 79 07
FX: +32 2 687 35 52
info@cdm-stravitec.com
www.cdm-stravitec.com

This drawing is exclusive property of CDM Stravitec, any reproduction or communication to third parties without prior authorisation is prohibited.

STRAVIFLOOR DECK W/ 50mm ELASTOMERIC PADS	
Typical Cross Section - Stravifloor Deck (EU)-01	
Design: VPR	Scale: 1 : 3
Check: CRU	Format: A3
2025/07/23	

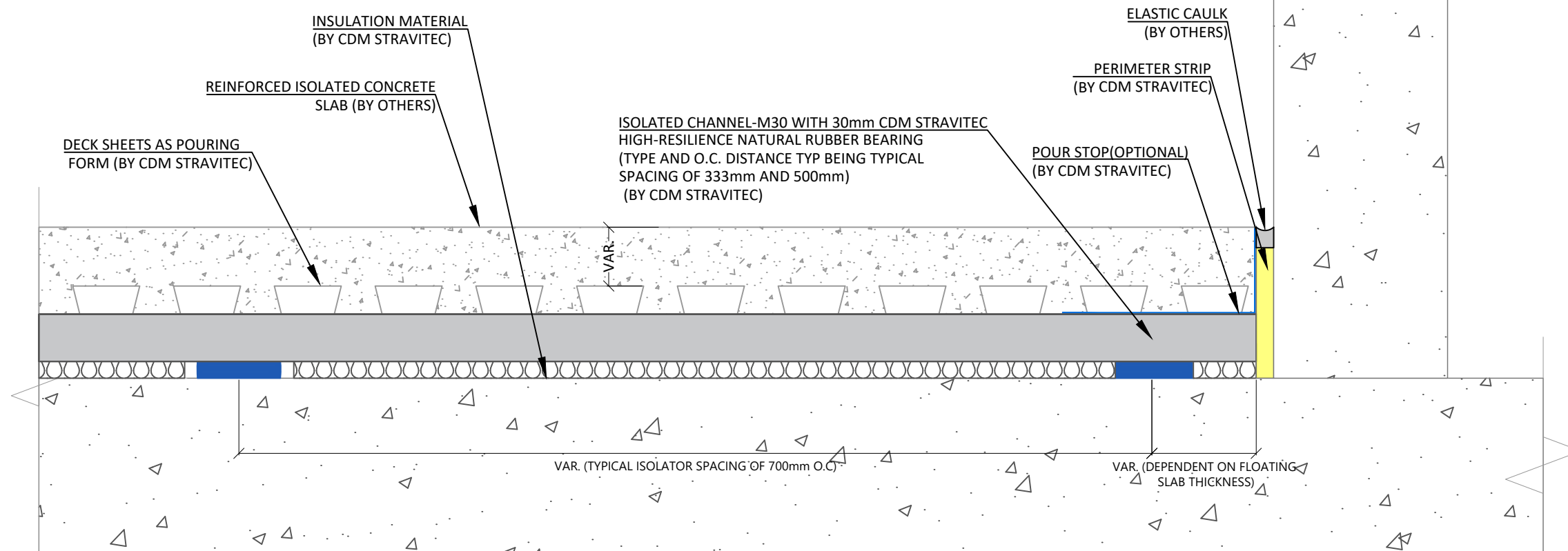

Longitudinal Section

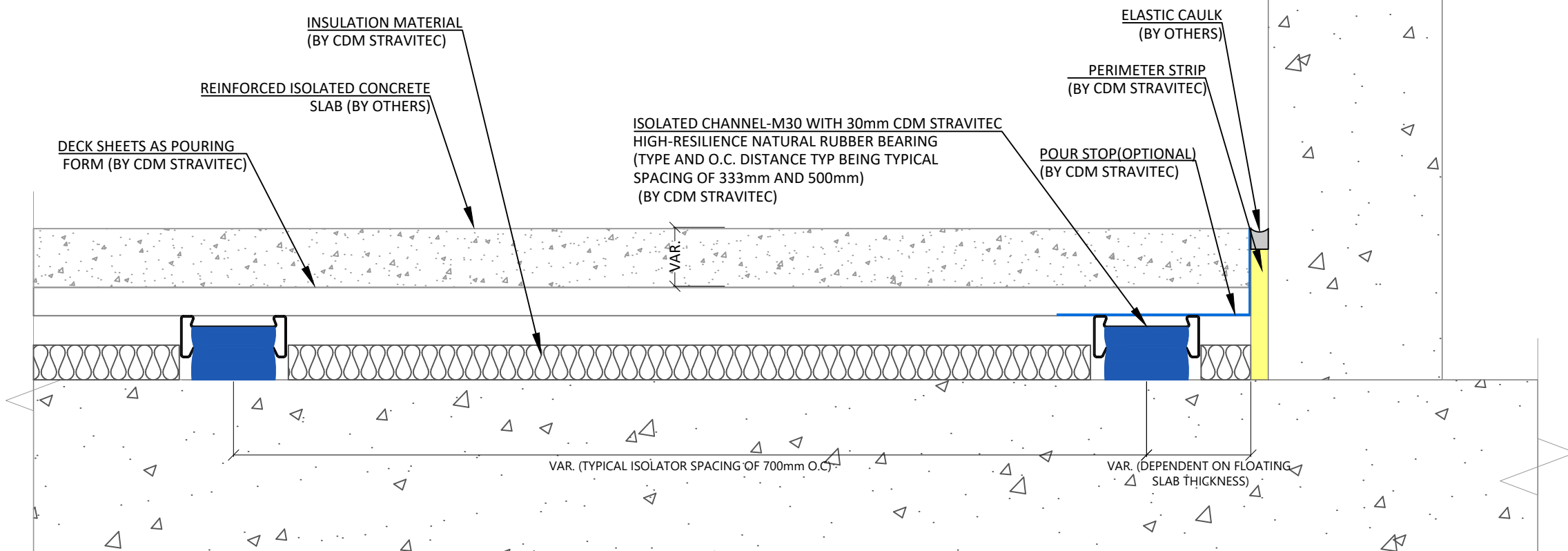

Lateral Section

Notes

System

Stravifloor Deck (EN)

1.

The structural floor should comply with the required tolerances regarding gradient (0,1 % or 1 mm/m) and smoothness (max. 2 mm). It should be dry and free of obstacles, discontinuities, dust, etc.

2.

A rigid connection between the floating slab and any vertical elements (e.g. walls, columns, ...) should be avoided by adding a perimeter strip between the isolated slab and the vertical element.

For more detailed information ask for Stravifloor Deck Installation Manual.

MINIMUM SYSTEM TOTAL BUILD-UP HEIGHT (BEFORE DEFLECTION): 87mm

Legend

First submission

2025/07/23

VPR

A

Revision Description

Date

Drawn

Rev.

Load table

Drawing based on

cdm

stravitec

Reutenbeek 9-11
B-3090 Overijse Belgium
PH: +32 2 687 79 07
FX: +32 2 687 35 52
info@cdm-stravitec.com
www.cdm-stravitec.com

This drawing is exclusive property of CDM Stravitec, any reproduction or communication to third parties without prior authorisation is prohibited.

STRAVIFLOOR DECK W/ 30mm ELASTOMERIC PADS

Typical Cross Section - Stravifloor Deck (EU)-02

Design: VPR

Check: CRU

Scale: 1 : 3

Format: A3

2025/07/23

Page 02 of 1

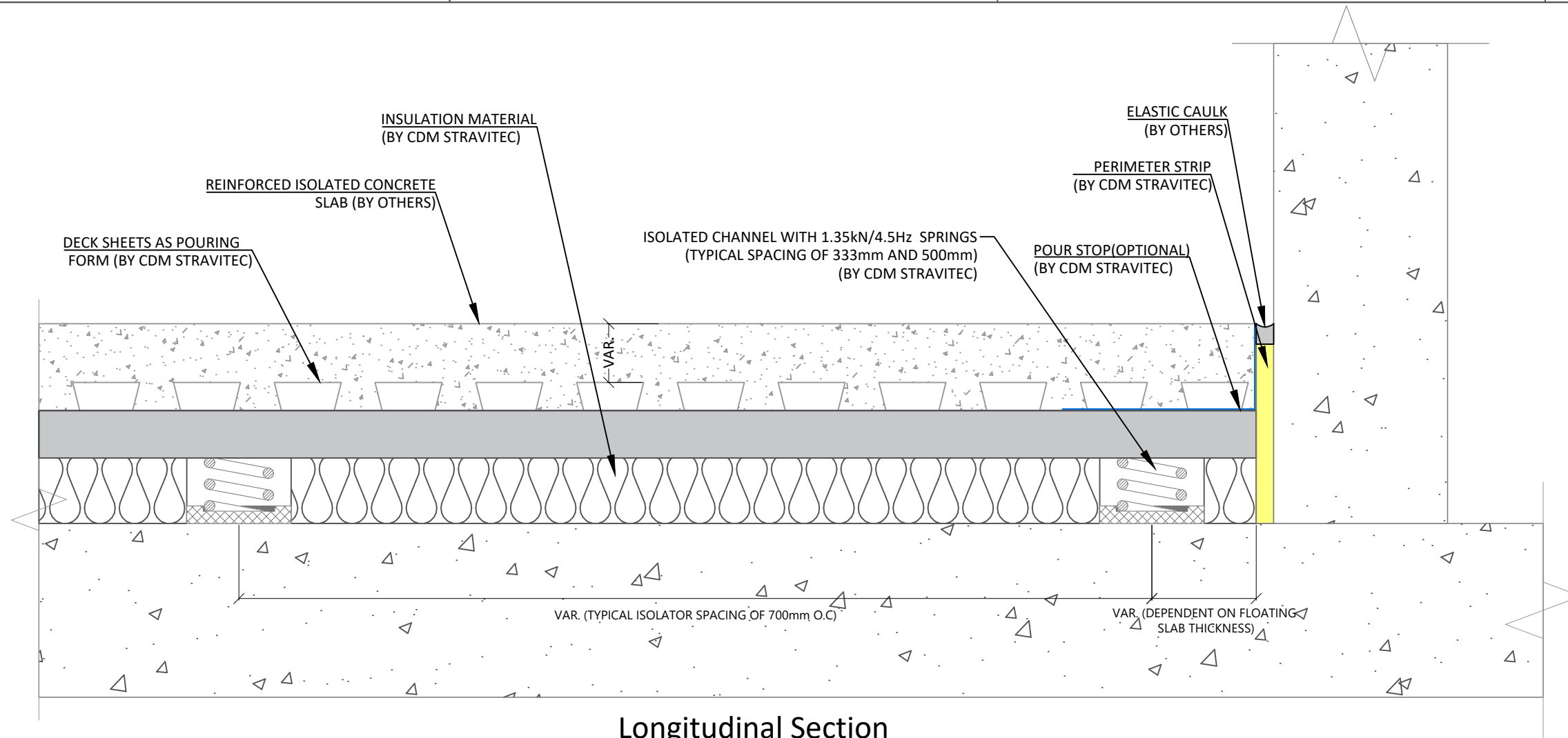

Longitudinal Section

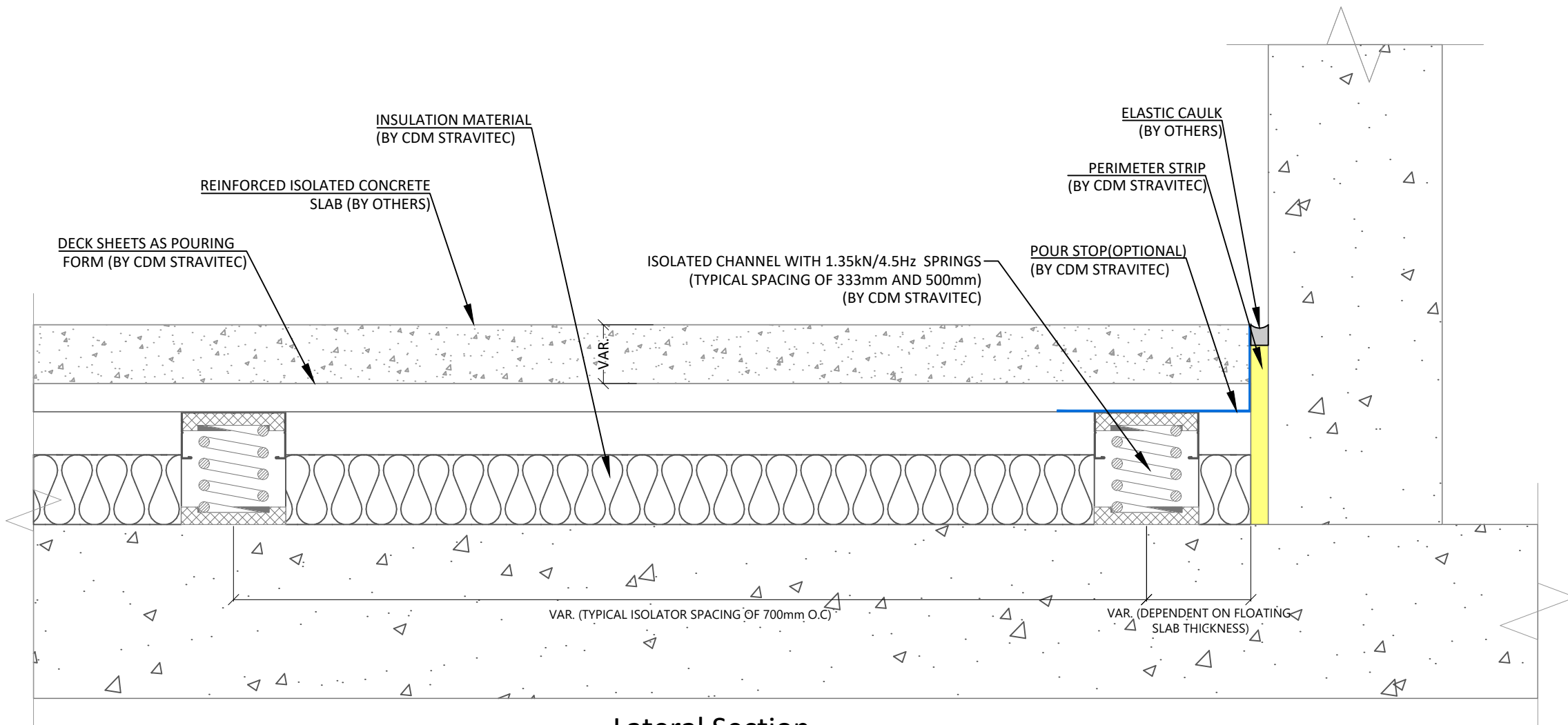

Lateral Section

Notes

System Stravifloor Deck (EN)

1. The structural floor should comply with the required tolerances regarding gradient (0,1 % or 1 mm/m) and smoothness (max. 2 mm). It should be dry and free of obstacles, discontinuities, dust, etc.
2. A rigid connection between the floating slab and any vertical elements (e.g. walls, columns, ...) should be avoided by adding a perimeter strip between the isolated slab and the vertical element.

For more detailed information ask for Stravifloor Deck Installation Manual.

MINIMUM SYSTEM TOTAL BUILD-UP HEIGHT (BEFORE DEFLECTION): 114mm

Legend

First submission	2025/07/23	VPR	A
Revision Description	Date	Drawn	Rev.

Load table

Drawing based on



Reutenbeek 9-11
B-3090 Overijse Belgium
PH: +32 2 687 79 07
FX: +32 2 687 35 52
info@cdm-stravitec.com
www.cdm-stravitec.com

This drawing is exclusive property of CDM Stravitec, any reproduction or communication to third parties without prior authorisation is prohibited.

STRAVIFLOOR DECK W/ 1.35KN/4.5HZ SPRINGS

Typical Cross Section - Stravifloor

Deck (EU)-03
VPR 2025/07/23

Design:  A3

Check:
CRU